

3.2 EPIC® D A - V I N C I H - B

Gehäuse / Hood / Capot

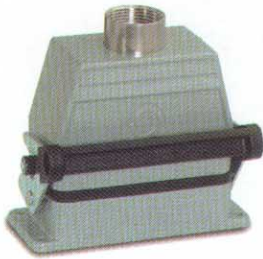

PG



M

EPIC® Standardgehäuse

Aluminiumlegierung, pulverbeschichtet (grau), Bügel und Bolzen aus verzinktem Stahl

Aluminium alloy, powder coated (grey), locking levers and bolts made of zinc plated steel

Alliage aluminium, recouvert par pulvérisation (grise), leviers et ergots acier recouvert par zinc

Für den industriellen Einsatz in anspruchsvoller Umgebung.

For industrial applications in demanding environments.

Pour une exploitation industrielle dans un environnement exigeant.

Entsprechend DIN EN 50262; auch in metrischer Ausführung mit M20-, M25-, M32- und M40-Gewinde.

According to DIN EN 50262; also available with metric thread M20, M25, M32 and M40.

Selon DIN EN 50262; maintenant aussi disponible avec pas métrique M20, M25, M32 et M40.



PG



M

EPIC® EP: (Environmental Protected/für erhöhte Umwelтанforderungen)

Aluminiumlegierung, pulverbeschichtet (schwarz), Bügel und Bolzen aus Edelstahl

Aluminium alloy, powder coated (black), locking levers and bolts made of stainless steel

Alliage aluminium, recouvert par pulvérisation (noir), leviers et ergots acier inox

Für den industriellen Einsatz in stark beanspruchter Umgebung mit aggressiver Atmosphäre.

For industrial applications in extremely demanding environments with aggressive atmospheres.

Pour l'exploitation industrielle dans un environnement très sollicité à atmosphère agressive.

Entsprechend DIN EN 50262; auch in metrischer Ausführung mit M20-, M25-, M32 und M40-Gewinde.

According to DIN EN 50262; now also available with metric thread M20, M25, M32 and M40.

Selon DIN EN 50262; maintenant aussi disponible avec pas métrique M20, M25, M32 et M40.

**Auf Anfrage
On request
sur demande**

3.2 EPIC® D A - V I N C I H - B

Gehäuse / Hood / Capot

VERGLEICH DER KLEMMBEREICHE FÜR EINSCHNITTDICHTUNGEN PG (DIN 46320) ZU METRISCH

Comparison of the thread dimensions for split seals PG thread (DIN 46320)/ metric thread

Comparaison de la dimension du filetage pour joints multiples pas PG (DIN 46320)/pas métrique

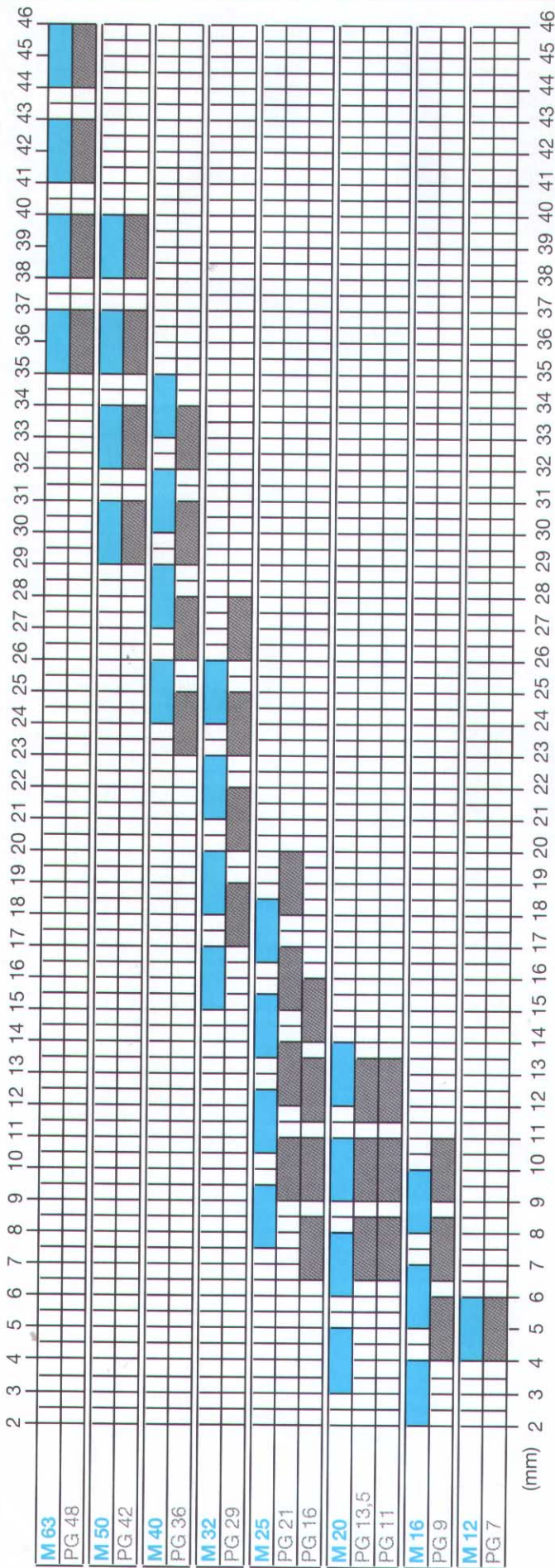

3.2 EPIC® D A - VINCI H - B

Gehäuse / Hood / Capot



PG



M

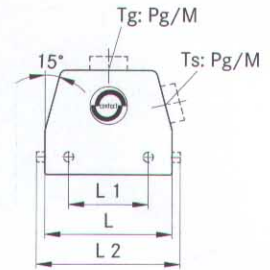
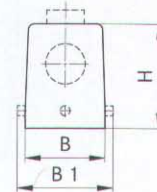

EPIC® H-B Gehäuse: Tüllengehäuse (Kabeleingang gerade, Bolzen für Längsbügel)

EPIC® H-B housings: hood (top entry, bolts for single locking lever)

Boîtiers EPIC® H-B: capot (sortie verticale, ergots pour simple levier)

H-B 6

Artikel part article	Art.Nr. part No. N° art.	PG	M	ZW	L	L1	L2	L3	L4	B	B1	B2	B3	B4	B5	H	H1	H2	S	d	
H-B 6 TG 13,5	10011000	13,5		●	60		74,8			43					45						
H-B 6 TG 16	10021000	16		●																	
H-B 6 TG M20	19011000		20		60		74,8			43											
H-B 6 TG M25	19021000		25																		

Einsätze / Inserts / Inserts: 1.4: H-BE 6 / 1.5: H-EE 10 / 1.9: H-DD 24 / 1.10: MC 6

Deckel / Cover / Couvercle: 6.1: H-BE 6

Kabelverschraubung / Cable gland / Presse-étoupe: 5.1: Metr. & PG

H-B 10

Artikel part article	Art.Nr. part No. N° art.	PG	M	ZW	L	L1	L2	L3	L4	B	B1	B2	B3	B4	B5	H	H1	H2	S	d	
H-B 10 TG-RO 16	10040900	16		●	73		90			43					45						
H-B 10 TG-RO 21	10040700	21		●																	
H-B 10 TG-RO M20	19040900		20		73		90			43					45						
H-B 10 TG-RO M25	19040700		25																		

Einsätze / Inserts / Inserts: 1.4: H-BE 10 / 1.5: H-EE 18 / 1.7: H-BVE 3 / 1.9: H-DD 42 / 1.10: MC 10

Kabelverschraubung / Cable gland / Presse-étoupe: 5.1: Metr. & PG



PG

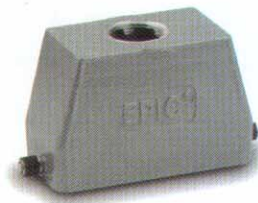

M

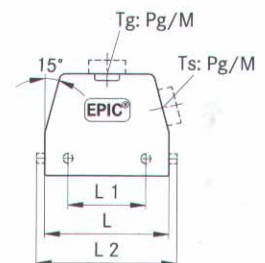
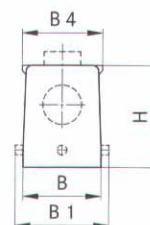

H-B 16

Artikel part article	Art.Nr. part No. N° art.	PG	M	ZW	L	L1	L2	L3	L4	B	B1	B2	B3	B4	B5	H	H1	H2	S	d	
H-B 16 TG-RO 21	10080900	21		●	93,3		110			43											
H-B 16 TG-RO M25	19080900		25		93,3		110			43											

Einsätze / Inserts / Inserts: 1.4: H-BE 16 / 1.5: H-EE 32 / 1.6: H-BS 6 / 1.7: H-BVE 6 / 1.8: H-D 40 / 1.9: H-DD 72 / 1.10: MC 16

Kabelverschraubung / Cable gland / Presse-étoupe: 5.1: Metr. & PG

3.2 EPIC® DA - VINCI H - B

Gehäuse / Hood / Capot



PG



M

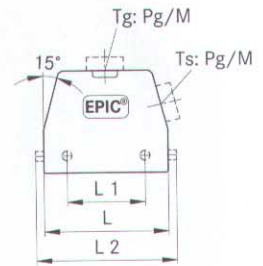
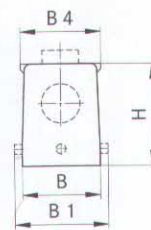

EPIC® H-B Gehäuse: Tüllengehäuse (Kabeleingang gerade, Bolzen für Längsbügel)
EPIC® H-B housings: hood (top entry, bolts for single locking lever)
Boîtiers EPIC® H-B: capot (sortie verticale, ergots pour simple levier)

H-B 24

Artikel part article	Art.Nr. part No. N° art.	PG	M	ZW	L	L1	L2	L3	L4	B	B1	B2	B3	B4	B5	H	H1	H2	S	d
H-B 24 TG-RO 21	10121900	21		●	120		137			43					45		61			
H-B 24 TG-RO 29	10111900	29		●																
H-B 24 TG-RO M25	19121900		25		120		137			43					45		61			
H-B 24 TG-RO M32	19111900		32																	

Einsätze / Inserts / Inserts: 1.4: H-BE 48 / 1.5: H-EE 46 / 1.7: H-BVE 10 / 1.8: H-D 64 / 1.9: H-DD 108 / 1.10: MC 24
 Kabelverschraubung / Cable gland / Presse-étoupe: 5.1: Metr. & PG

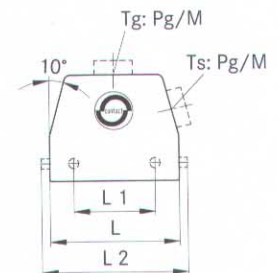
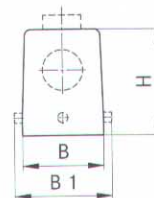
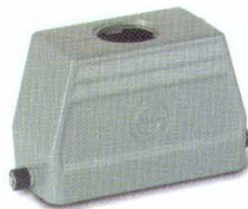

H-B 48

Artikel part article	Art.Nr. part No. N° art.	PG	M	ZW	L	L1	L2	L3	L4	B	B1	B2	B3	B4	B5	H	H1	H2	S	d
H-B 48 TG 29	10155000	29		●																
H-B 48 TG 36	10156000	36		●	132		152			90					45		105			
H-B 48 TG 36	10156200	36																		
H-B 48 TG 42	10157000	42																		
H-B 48 TG M32	19155000		32																	
H-B 48 TG M40	19156000		40		132		152			90					45		105			
H-B 48 TG M50	19157000		50																	

Einsätze / Inserts / Inserts: 1.4: H-BE 48 / 1.5: H-EE 92 / 1.7: 2 x H-BVE 10 / 1.8: H-D 128 / 1.9: H-DD 216 / 1.10: 2 x MC 24
 Kabelverschraubung / Cable gland / Presse-étoupe: 5.1: Metr. & PG

3.2 EPIC® D A - VINCI H - B

Gehäuse / Hood / Capot



PG



M

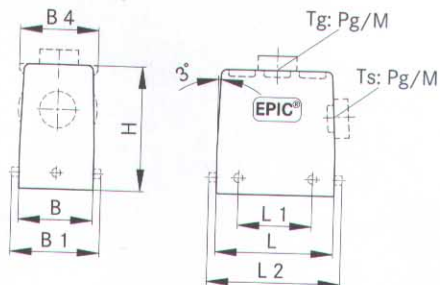

EPIC® H-B Gehäuse: Tüllengehäuse (Kabeleingang gerade, Bolzen für Längsbügel, hohe Bauform)
EPIC® H-B housings: hood (top entry, bolts for single locking lever, high version)
Boîtiers EPIC® H-B: capot (sortie verticale, ergots pour simple levier, version haute)

H-B 16

Artikel part article	Art.Nr. part No. N° art.	PG	M	ZW	L	L1	L2	L3	L4	B	B1	B2	B3	B4	B5	H	H1	H2	S	d
H-B 16 TGH-RO 21	70094200	21		●	93,3		110			43				45		76				
H-B 16 TGH-RO 29	70094400	29		●	93,3		110			43				45		76				
H-B 16 TGH-RO M25	79094200		25																	
H-B 16 TGH-RO M32	79094400		32		93,3		110			43				45		76				
H-B 16 TGH-RO M40	79094600		40																	

Einsätze / Inserts / Inserts: 1.4: H-BE 16 / 1.5: H-EE 32 / 1.6: H-BS 6 / 1.7: H-BVE 6 / 1.8: H-D 40 / 1.9: H-DD 72 / 1.10: MC 16
 Kabelverschraubung / Cable gland / Presse-étoupe: 5.1: Metr. & PG

H-B 24

Artikel part article	Art.Nr. part No. N° art.	PG	M	ZW	L	L1	L2	L3	L4	B	B1	B2	B3	B4	B5	H	H1	H2	S	d
H-B 24 TGH-RO 21	70144400	21		●	120		137			43				45		76				
H-B 24 TGH-RO 29	70144600	29		●	120		137			43				45		76				
H-B 24 TGH-RO M25	79144400		25																	
H-B 24 TGH-RO M32	79144600		32		120		137			43				45		76				
H-B 24 TGH-RO M40	79144800		40																	

Einsätze / Inserts / Inserts: 1.4: H-BE 24 / 1.5: H-EE 46 / 1.7: H-BVE 10 / 1.8: H-D 64 / 1.9: H-DD 108 / 1.10: MC 24
 Kabelverschraubung / Cable gland / Presse-étoupe: 5.1: Metr. & PG

3.2 EPIC® D A - VINCI H - B

Gehäuse / Hood / Capot

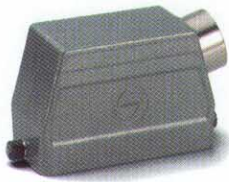

PG / M

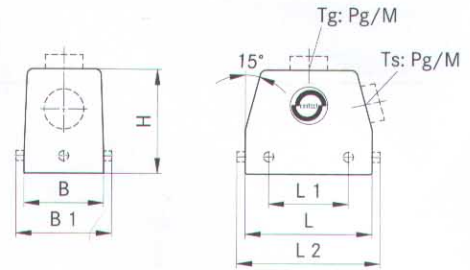

EPIC® H-B Gehäuse: Tüllengehäuse (Kabeleingang seitlich, Bolzen für Längsbügel)

EPIC® H-B housings: hood (side entry, bolts for single locking lever)

Boîtiers EPIC® H-B: capot (sortie latérale, ergots pour simple levier)

H-B 6

Artikel part article	Art.Nr. part No. N° art.	PG	M	ZW	L	L1	L2	L3	L4	B	B1	B2	B3	B4	B5	H	H1	H2	S	d
H-B 6 TS 13,5	10012000	13,5		●	60		74,8			43						52				
H-B 6 TS 16	10022000	16		●																
H-B 6 TS M20	19012000		20	●	60		74,8			43						52				
H-B 6 TS M25	19022000		25	●																

Einsätze / Inserts / Inserts: 1.4: H-BE 6 / 1.5: H-EE 10 / 1.9: H-DD 24 / 1.10: MC 6

Deckel / Cover / Couvercle: 6.1: H-B 6

Kabelverschraubung / Cable gland / Presse-étoupe: 5.1: Metr. & PG

H-B 10

Artikel part article	Art.Nr. part No. N° art.	PG	M	ZW	L	L1	L2	L3	L4	B	B1	B2	B3	B4	B5	H	H1	H2	S	d
H-B 10 TS-RO 16	10042900	16		●	73		90			43						52				
H-B 10 TS-RO 21	10042800	21		●																
H-B 10 TS-RO M20	19042900		20	●	73		90			43						52				
H-B 10 TS-RO M25	19042800		25	●																

Einsätze / Inserts / Inserts: 1.4: H-BE 10 / 1.5: H-EE 18 / 1.7: H-BVE 3 / 1.9: H-DD 42 / 1.10: MC 10

Kabelverschraubung / Cable gland / Presse-étoupe: 5.1: Metr. & PG



PG / M

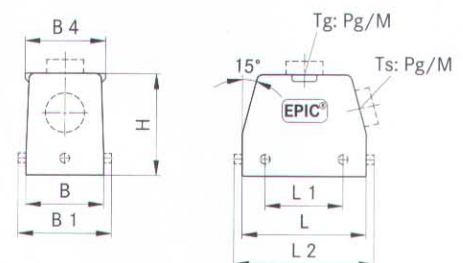

H-B 16

Artikel part article	Art.Nr. part No. N° art.	PG	M	ZW	L	L1	L2	L3	L4	B	B1	B2	B3	B4	B5	H	H1	H2	S	d
H-B 16 TS-RO 21	10082900	21		●	93,3		110			43				45		61				
H-B 16 TS-RO 29	10092900	29		●																
H-B 16 TS-RO M25	19082900		25	●	93,3		110			43				45		61				
H-B 16 TS-RO M32	19092900		32	●																

Einsätze / Inserts / Inserts: 1.4: H-BE 16 / 1.5: H-EE 32 / 1.6: H-BS 6 / 1.7: H-BVE 6 / 1.8: H-D 40 / 1.9: H-DD 72 / 1.10: MC 16

Kabelverschraubung / Cable gland / Presse-étoupe: 5.1: Metr. & PG