

# 3.2 EPIC® D A - V I N C I H - B

Sockelgehäuse / Surface mount base / Embase en saillie

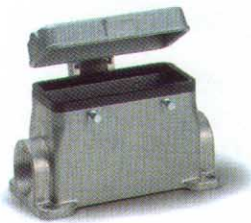

PG / M

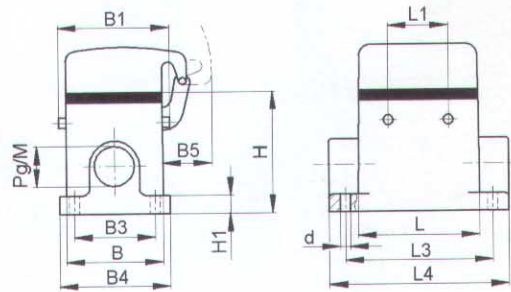

**EPIC® H-B Gehäuse: Sockelgehäuse (Schutzdeckel, 2 Kabeleingänge, Bolzen für Querbügel)**

**EPIC® H-B housings: surface mount base (cover, 2 cable entries, bolts for double locking lever)**

**Boîtiers EPIC® H-B: embase en saillie (couvercle, 2 entrées de câble, ergots pour double levier)**

## H-B 10

Artikel part article	Art.Nr. part No. N° art.	PG	M	L	L1	L2	L3	L4	B	B1	B2	B3	B4	B5	H	H1	H2	S	d
H-B 10 SDRL-BO 16	<b>10038000</b>		16	73	27		82	94	43	57,8		40	52	25	57	4,5			5,5
H-B 10 SDRL-BO M20	<b>19038000</b>		20	73	27		82	94	43	57,8		40	52	25	57	4,5			5,5
H-B 10 SDRL-BO M25	<b>79046600</b>		25																

Einsätze / Inserts / Inserts: 1.4: H-BE 10 / 1.5: H-EE 18 / 1.7: H-BVE 3 / 1.9: H-DD 42 / 1.10: MC 10  
Kabelverschraubung / Cable gland / Presse-étoupe: 5.1: Metr. & PG

## H-B 16

Artikel part article	Art.Nr. part No. N° art.	PG	M	L	L1	L2	L3	L4	B	B1	B2	B3	B4	B5	H	H1	H2	S	d
H-B 16 SDRL-BO 21	<b>70096000</b>		21	93	47,5		105	117	43	57,8		45	57	25	64	4,5			5,5
H-B 16 SDRL-BO M25	<b>79096000</b>		25	93	47,5		105	117	43	57,8		45	57	25	64	4,5			5,5

Einsätze / Inserts / Inserts: 1.4: H-BE 16 / 1.5: H-EE 32 / 1.6: H-BS 6 / 1.7: H-BVE 6 / 1.8: H-D 40 / 1.9: H-DD 72 / 1.10: MC 16  
Kabelverschraubung / Cable gland / Presse-étoupe: 5.1: Metr. & PG

## H-B 24

Artikel part article	Art.Nr. part No. N° art.	PG	M	L	L1	L2	L3	L4	B	B1	B2	B3	B4	B5	H	H1	H2	S	d
H-B 24 SDRL-BO 21	<b>10109000</b>		21	120	74		132	144	43	57,8		45	57	25	64	4,5			5,5
H-B 24 SDRL-BO M25	<b>19109000</b>		25	120	74		132	144	43	57,8		45	57	25	64	4,5			5,5

Einsätze / Inserts / Inserts: 1.4: H-BE 24 / 1.5: H-EE 46 / 1.7: H-BVE 10 / 1.8: H-D 64 / 1.9: H-DD 108 / 1.10: MC 24  
Kabelverschraubung / Cable gland / Presse-étoupe: 5.1: Metr. & PG

# 3.2 EPIC® D A - V I N C I H - B

Sockelgehäuse / Surface mount base / Embase en saillie



PG / M

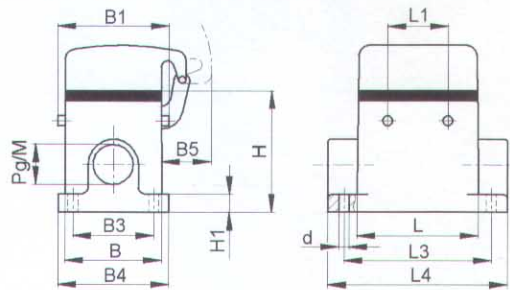

EPIC® H-B Gehäuse: Sockelgehäuse (Schutzdeckel, 2 Kabeleingänge, Bolzen für Querbügel, hohe Bauform)

EPIC® H-B housings: surface mount base (cover, 2 cable entries, bolts for double locking lever, high version)

Boîtiers EPIC® H-B: embase en saillie (covercle, 2 entrées de câble, ergots pour double levier, version haute)

## H-B 10

Artikel part article	Art.Nr. part No. N° art.	PG	M	L	L1	L2	L3	L4	B	B1	B2	B3	B4	B5	H	H1	H2	S	d
H-B 10 SDR LH-BO 21	70046200	21		73	27		82	97	43	57,8		45	58	25	74	6			5,5
H-B 10 SDR LH-BO 29	70046400	29		73	27		82	97	43	57,8		45	58	25	74	6			5,5
H-B 10 SDR LH-BO M25	79046200		25	73	27		82	97	43	57,8		45	58	25	74	6			5,5
H-B 10 SDR LH-BO M32	79046400		32	73	27		82	97	43	57,8		45	58	25	74	6			5,5

Einsätze / Inserts / Inserts: 1.4: H-BE 10 / 1.5: H-EE 18 / 1.7: H-BVE 3 / 1.9: H-DD 42 / 1.10: MC 10

Kabelverschraubung / Cable gland / Presse-étoupe: 5.1: Metr. & PG

## H-B 16

Artikel part article	Art.Nr. part No. N° art.	PG	M	L	L1	L2	L3	L4	B	B1	B2	B3	B4	B5	H	H1	H2	S	d
H-B 16 SDR LH-BO 21	70096200	21		93,3	47,5		105	117	43	57,8		45	58	25	84	6			5,5
H-B 16 SDR LH-BO 29	70096400	29		93,3	47,5		105	117	43	57,8		45	58	25	84	6			5,5
H-B 16 SDR LH-BO M25	79096200		25	93,3	47,5		105	117	43	57,8		45	58	25	84	6			5,5
H-B 16 SDR LH-BO M32	79096400		32	93,3	47,5		105	117	43	57,8		45	58	25	84	6			5,5

Einsätze / Inserts / Inserts: 1.4: H-BE 16 / 1.5: H-EE 32 / 1.6: H-BS 6 / 1.7: H-BVE 6 / 1.8: H-D 40 / 1.9: H-DD 72 / 1.10: MC 16

Kabelverschraubung / Cable gland / Presse-étoupe: 5.1: Metr. & PG

## H-B 24

Artikel part article	Art.Nr. part No. N° art.	PG	M	L	L1	L2	L3	L4	B	B1	B2	B3	B4	B5	H	H1	H2	S	d
H-B 24 SDR LH-BO 21	70146200	21		120	74		132	144	43	57,8		45	58	25	84	6			5,5
H-B 24 SDR LH-BO 29	70146400	29		120	74		132	144	43	57,8		45	58	25	84	6			5,5
H-B 24 SDR LH-BO M25	79146200		25	120	74		132	144	43	57,8		45	58	25	84	6			5,5
H-B 24 SDR LH-BO M32	79146400		32	120	74		132	144	43	57,8		45	58	25	84	6			5,5

Einsätze / Inserts / Inserts: 1.4: H-BE 24 / 1.5: H-EE 46 / 1.7: H-BVE 10 / 1.8: H-D 64 / 1.9: H-DD 108 / 1.10: MC 24

Kabelverschraubung / Cable gland / Presse-étoupe: 5.1: Metr. & PG

# 3.2 EPIC® D A - V I N C I H - B

Sockelgehäuse / Surface mount base / Embase en saillie

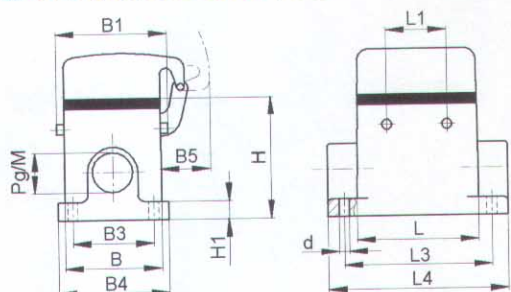

PG / M

**EPIC® H-B Gehäuse: Sockelgehäuse (Schutzdeckel, 1 Kabeleingang, Bolzen für Querbügel)**  
**EPIC® H-B housings: surface mount base (cover, 1 cable entry, bolts for double locking lever)**  
**Boîtiers EPIC® H-B: embase en saillie (couvercle, 1 entrée de câble, ergots pour double levier)**

## H-B 10

Artikel part article	Art.Nr. part No. N° art.	PG	M	L	L1	L2	L3	L4	B	B1	B2	B3	B4	B5	H	H1	H2	S	d
H-B 10 SDR-BO 16	<b>10036000</b>		16	73	27		82	94	43	57,8		40	52	25	57	4,5			5,5
H-B 10 SDR-BO M20	<b>19036000</b>		20	73	27		82	94	43	57,8		40	52	25	57	4,5			5,5
H-B 10 SDR-BO M25	<b>19036100</b>		25																

Einsätze / Inserts / Inserts: 1.4: H-BE 10 / 1.5: H-EE 18 / 1.7: H-BVE 3 / 1.9: H-DD 42 / 1.10: MC 10  
 Kabelverschraubung / Cable gland / Presse-étoupe: 5.1: Metr. & PG

## H-B 16

Artikel part article	Art.Nr. part No. N° art.	PG	M	L	L1	L2	L3	L4	B	B1	B2	B3	B4	B5	H	H1	H2	S	d
H-B 16 SDR-BO 21	<b>10076000</b>		21	93	47,5		105	117	43	57,8		45	57	25	64	4,5			5,5
H-B 16 SDR-BO M25	<b>19076000</b>		25	93	47,5		105	117	43	57,8		45	57	25	64	4,5			5,5

Einsätze / Inserts / Inserts: 1.4: H-BE 16 / 1.5: H-EE 32 / 1.6: H-BS 6 / 1.7: H-BVE 6 / 1.8: H-D 40 / 1.9: H-DD 72 / 1.10: MC 16  
 Kabelverschraubung / Cable gland / Presse-étoupe: 5.1: Metr. & PG

## H-B 24

Artikel part article	Art.Nr. part No. N° art.	PG	M	L	L1	L2	L3	L4	B	B1	B2	B3	B4	B5	H	H1	H2	S	d
H-B 24 SDR-BO 21	<b>10107000</b>		21	120	74		132	144	43	57,8		45	57	25	64	4,5			5,5
H-B 24 SDR-BO M25	<b>19107000</b>		25	120	74		132	144	43	57,8		45	57	25	64	4,5			5,5

Einsätze / Inserts / Inserts: 1.4: H-BE 24 / 1.5: H-EE 46 / 1.7: H-BVE 10 / 1.8: H-D 64 / 1.9: H-DD 108 / 1.10: MC 24  
 Kabelverschraubung / Cable gland / Presse-étoupe: 5.1: Metr. & PG

# 3.2 EPIC® D A - VINCI H - B

Sockelgehäuse / Surface mount base / Embase en saillie

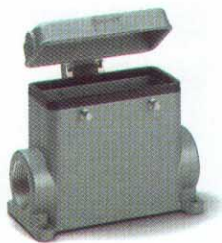

PG / M

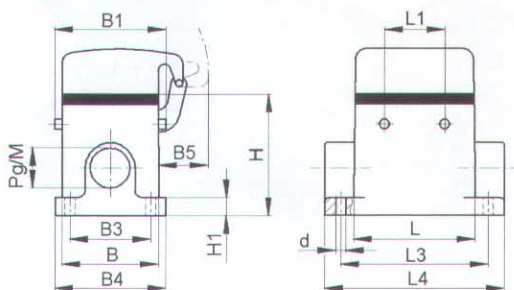

EPIC® H-B Gehäuse: Sockelgehäuse (Schutzdeckel, 1 Kabeleingang, Bolzen für Querbügel, hohe Bauform)

EPIC® H-B housings: surface mount base (cover, 1 cable entry, bolts for double locking lever, high version)

Boîtiers EPIC® H-B: embase en saillie (covercle, 1 entrée de câble, ergots pour double levier, version haute)

## H-B 10

Artikel part article	Art.Nr. part No. N° art.	PG	M	L	L1	L2	L3	L4	B	B1	B2	B3	B4	B5	H	H1	H2	S	d		
H-B 10 SDRH-BO 21	<b>70045200</b>	21																			
H-B 10 SDRH-BO 29	<b>70045400</b>	29		73	27		82	97	43	57,8		45	58	25	74	6				5,5	
H-B 10 SDRH-BO M25	<b>79045200</b>		25																		
H-B 10 SDRH-BO M32	<b>79045400</b>		32	73	27		82	97	43	57,8		45	58	25	74	6					5,5

Einsätze / Inserts / Inserts: 1.4: H-BE 10 / 1.5: H-EE 18 / 1.7: H-BVE 3 / 1.9: H-DD 42 / 1.10: MC 10

Kabelverschraubung / Cable gland / Presse-étoupe: 5.1: Metr. & PG

## H-B 16

Artikel part article	Art.Nr. part No. N° art.	PG	M	L	L1	L2	L3	L4	B	B1	B2	B3	B4	B5	H	H1	H2	S	d			
H-B 16 SDRH-BO 21	<b>70095200</b>	21																				
H-B 16 SDRH-BO 29	<b>70095400</b>	29		93,3	47,5		105	117	43	57,8		45	58	25	84	6					5,5	
H-B 16 SDRH-BO M25	<b>79095200</b>		25																			
H-B 16 SDRH-BO M32	<b>79095400</b>		32	93,3	47,5		105	117	43	57,8		45	58	25	84	6						5,5

Einsätze / Inserts / Inserts: 1.4: H-BE 16 / 1.5: H-EE 32 / 1.6: H-BS 6 / 1.7: H-BVE 6 / 1.8: H-D 40 / 1.9: H-DD 72 / 1.10: MC 16

Kabelverschraubung / Cable gland / Presse-étoupe: 5.1: Metr. & PG

## H-B 24

Artikel part article	Art.Nr. part No. N° art.	PG	M	L	L1	L2	L3	L4	B	B1	B2	B3	B4	B5	H	H1	H2	S	d				
H-B 24 SDRH-BO 21	<b>70145200</b>	21																					
H-B 24 SDRH-BO 29	<b>70145400</b>	29		120	74		132	144	43	57,8		45	58	25	84	6						5,5	
H-B 24 SDRH-BO M25	<b>79145200</b>		25																				
H-B 24 SDRH-BO M32	<b>79145400</b>		32	120	74		132	144	43	57,8		45	58	25	84	6							5,5

Einsätze / Inserts / Inserts: 1.4: H-BE 24 / 1.5: H-EE 46 / 1.7: H-BVE 10 / 1.8: H-D 64 / 1.9: H-DD 108 / 1.10: MC 24

Kabelverschraubung / Cable gland / Presse-étoupe: 5.1: Metr. & PG

# 3.2 EPIC® D A - V I N C I H - B

Kupplungsgehäuse / Cable coupler hood / Capot prolongateur

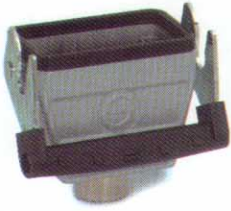

PG



M

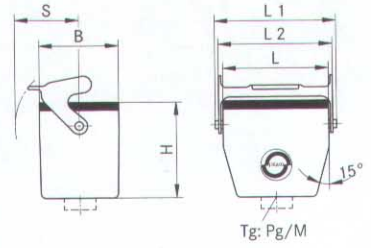

**EPIC® H-B Gehäuse: Kupplungsgehäuse (Kabeleingang gerade, Längsbügel)**  
**EPIC® H-B housings: cable coupler hood (top entry, single locking lever)**  
**Boîtiers EPIC® H-B: capot prolongateur (sortie verticale, simple levier)**

## H-B 6

Artikel part article	Art.Nr. part No. N° art.	PG	M	ZW	L	L1	L2	L3	L4	B	B1	B2	B3	B4	B5	H	H1	H2	S	d
H-B 6 TBF 13,5	<b>10014000</b>		13,5	●	60	74,8	70			43						54,8			44	
H-B 6 TBF 16	<b>10024000</b>		16	●																
H-B 6 TBF M20	<b>19014000</b>		20		60	74,8	70			43						54,8			44	
H-B 6 TBF M25	<b>19024000</b>		25																	

Einsätze / Inserts / Inserts: 1.4: H-BE 6 / 1.5: H-EE 10 / 1.9: H-DD 24 / 1.10: MC 6  
 Deckel / Cover / Couvercle: 6.1: H-B 6  
 Kabelverschraubung / Cable gland / Presse-étoupe: 5.1: Metr. & PG

## H-B 10

Artikel part article	Art.Nr. part No. N° art.	PG	M	ZW	L	L1	L2	L3	L4	B	B1	B2	B3	B4	B5	H	H1	H2	S	d
H-B 10 TBF-LB 16	<b>10046900</b>		16	●	73	91	88,5			43						54,8			50	
H-B 10 TBF-LB 21	<b>70042200</b>		21	●																
H-B 10 TBF-LB M20	<b>19046900</b>		20		73	91	88,5			43						54,8			50	
H-B 10 TBF-LB M25	<b>79042200</b>		25																	

Einsätze / Inserts / Inserts: 1.4: H-BE 10 / 1.5: H-EE 18 / 1.7: H-BVE 3 / 1.9: H-DD 42 / 1.10: MC 10  
 Kabelverschraubung / Cable gland / Presse-étoupe: 5.1: Metr. & PG

# 3.2 EPIC® D A - V I N C I H - B

Kupplungsgehäuse / Cable coupler hood / Capot prolongateur



PG



M

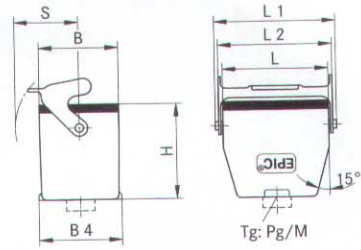

**EPIC® H-B Gehäuse: Kupplungsgehäuse (Kabeleingang gerade, Längsbügel)**  
**EPIC® H-B housings: cable coupler hood (top entry, single locking lever)**  
**Boîtiers EPIC® H-B: capot prolongateur (sortie verticale, simple levier)**

## H-B 16

Artikel part article	Art.Nr. part No. N° art.	PG	M	ZW	L	L1	L2	L3	L4	B	B1	B2	B3	B4	B5	H	H1	H2	S	d
H-B 16 TBF-LB 21	<b>10086900</b>	21		●	93,3	111	109,5			43						63,5			50	
H-B 16 TBF-LB M25	<b>19086900</b>		25		93,3	111	109,5			43						63,5			50	

Einsätze / Inserts / Inserts: 1.4: H-BE 16 / 1.5: H-EE 32 / 1.6: H-BS 6 / 1.7: H-BVE 6 / 1.8: H-D 40 / 1.9: H-DD 72 / 1.10: MC 16  
 Kabelverschraubung / Cable gland / Presse-étoupe: 5.1: Metr. & PG

## H-B 24

Artikel part article	Art.Nr. part No. N° art.	PG	M	ZW	L	L1	L2	L3	L4	B	B1	B2	B3	B4	B5	H	H1	H2	S	d
H-B 24 TBF-LB 21	<b>10127900</b>	21		●	120	138	136,5			43						63,8			50	
H-B 24 TBF-LB 29	<b>10117900</b>		29		120	138	136,5			43						63,8			50	
H-B 24 TBF-LB M25	<b>19127900</b>		25		120	138	136,5			43						63,8			50	
H-B 24 TBF-LB M32	<b>19117900</b>		32																	

Einsätze / Inserts / Inserts: 1.4: H-BE 24 / 1.5: H-EE 46 / 1.7: H-BVE 10 / 1.8: H-D 64 / 1.9: H-DD 108 / 1.10: MC 24  
 Kabelverschraubung / Cable gland / Presse-étoupe: 5.1: Metr. & PG



# 3.2 EPIC® D A - V I N C I H - B

Kupplungsgehäuse / Cable coupler hood / Capot prolongateur



PG



M

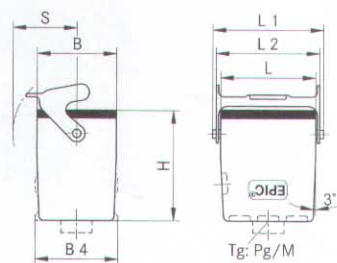

**EPIC® H-B Gehäuse: Kupplungsgehäuse (Kabeleingang gerade, Längsbügel, hohe Bauform)**

*EPIC® H-B housings: cable coupler hood (top entry, single locking lever, high version)*

*Boîtiers EPIC® H-B: capot prolongateur (sortie verticale, simple levier, version haute)*

## H-B 6

Artikel part article	Art.Nr. part No. N° art.	PG	M	ZW	L	L1	L2	L3	L4	B	B1	B2	B3	B4	B5	H	H1	H2	S	d
H-B 6 TBFH 21	<b>70010200</b>	21		●	60	74,8	70			43						74,8				44
H-B 6 TBFH 29	<b>70010400</b>	29		●																
H-B 6 TBFH M25	<b>79010200</b>		25		60	74,8	70			43						74,8				44
H-B 6 TBFH M32	<b>79010400</b>		32																	

Einsätze / Inserts / Inserts: 1.4: H-BE 6 / 1.5: H-EE 10 / 1.9: H-DD 24 / 1.10: MC 6

Deckel / Cover / Couvercle: 6.1: H-B 6

Kabelverschraubung / Cable gland / Presse-étoupe: 5.1: Metr. & PG

## H-B 10

Artikel part article	Art.Nr. part No. N° art.	PG	M	ZW	L	L1	L2	L3	L4	B	B1	B2	B3	B4	B5	H	H1	H2	S	d
H-B 10 TBFH-LB 21	<b>70042400</b>	21		●	73	91	88,5			43						74,8				50
H-B 10 TBFH-LB 29	<b>70042600</b>	29		●																
H-B 10 TBFH-LB M25	<b>79042400</b>		25		73	91	88,5			43						74,8				50
H-B 10 TBFH-LB M32	<b>79042600</b>		32																	

Einsätze / Inserts / Inserts: 1.4: H-BE 10 / 1.5: H-EE 18 / 1.7: H-BVE 3 / 1.9: H-DD 42 / 1.10: MC 10

Kabelverschraubung / Cable gland / Presse-étoupe: 5.1: Metr. & PG

3